

16192A-03A

S E R V I C E N O T E

Supersedes:
16192A-03

16192A Parallel Electrode SMD Test Fixture

Serial Numbers: Non-RoHS Fixture

“MY43100001 - MY43199999; SG43100001 – SG43199999”

OR

RoHS Fixture

“MY43200001 – MY43299999; SG43200001 – SG43299999”

This service note provides the updated part numbers and figures for both RoHS and non-RoHS 16192A Parallel Electrode SMD Test Fixture.

Parts Required:

Parts required depends on whether RoHS or non-RoHS 16192A is serviced.

Non- RoHS unit – Refer to [Situation 1](#)

RoHS unit – Refer to [Situation 2](#)

ADMINISTRATIVE INFORMATION

SERVICE NOTE CLASSIFICATION:	
INFORMATION ONLY	
<input type="checkbox"/> Calibration Required	PRODUCT LINE: WN
<input checked="" type="checkbox"/> Calibration NOT Required	AUTHOR: LS
ADDITIONAL INFORMATION: Support part information for non-RoHS and RoHS 16192A Parallel Electrode SMD Test Fixture.	

© AGILENT TECHNOLOGIES, INC. 2013
PRINTED IN U.S.A.

May 7, 2013

Rev. 21



Situation 1:
For non-RoHS 16192A Parallel Electrode SMD Test Fixture
(S/N: MY431xxxxx and below, SG431xxxxx and below)

Solution/Action:

Shown are the supported parts and their respective RoHS compliant replacement support part. RoHS conversion involves with design and dimension change which result in the RoHS support part backward incompatible with non-RoHS 16192A Parallel Electrode SMD Test Fixture. Special handling is needed while using the RoHS replacement part on non-RoHS 16192A. The original support part number is replaced by the respective “RoHS Compliant Replacement Part”. Once the original support part is depleted, please proceed to obtain the RoHS compliant support part. Please refer to table 1-1, 1-2, 1-3, 1-4, 1-5, 1-6 and figure 1-1, 1-2, 1-3, 1-4, 1-5, 1-6 for the respective replacement part accordingly.

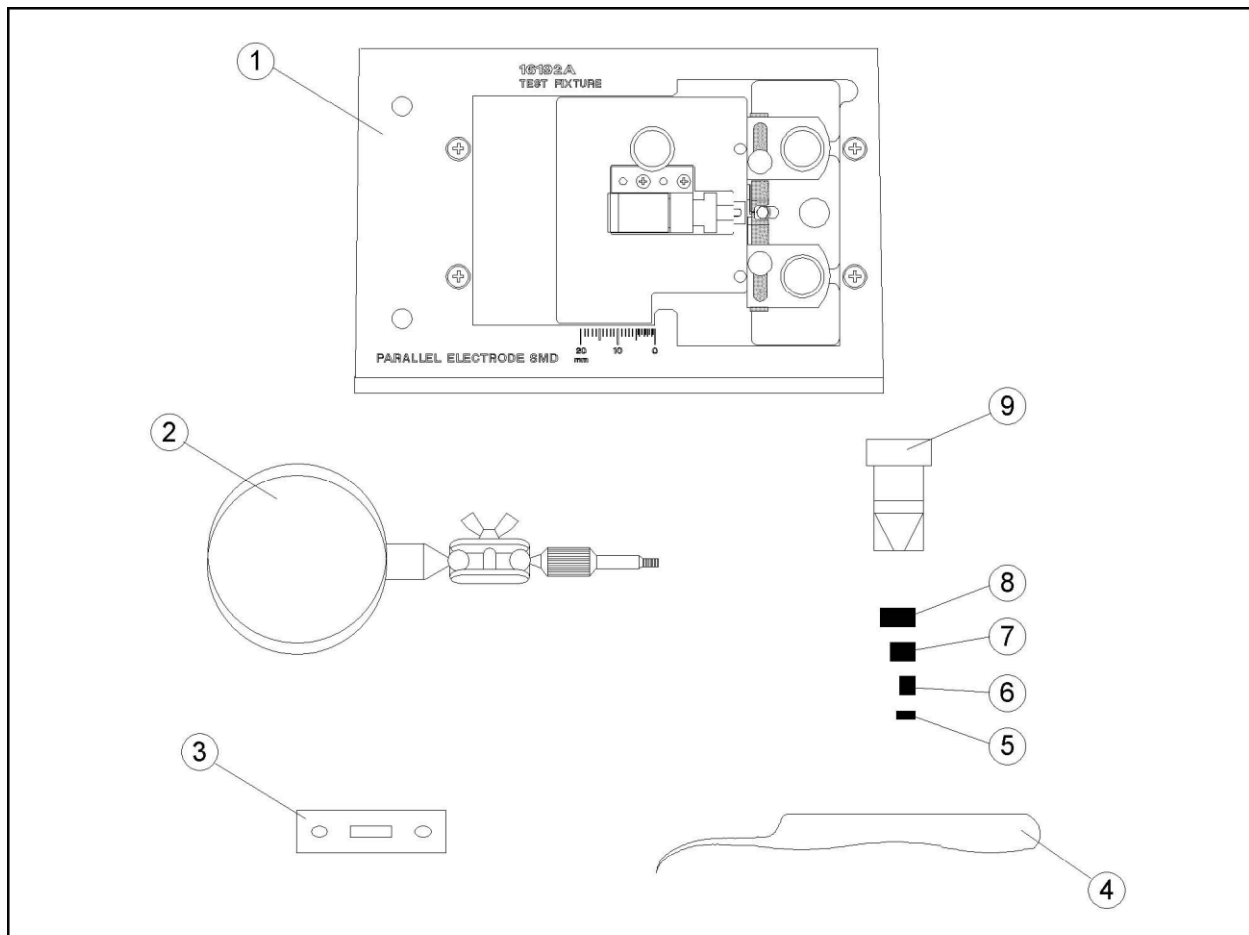

ac104010

Figure 1-1

NOTE: For RoHS Compliant Upper Level Assembly Replacement Part, if multiple parts are replaced by a common higher assembly part, only order ONE part of the higher level common assembly.

Shown in table 1-1, 1-2, 1-3, 1-4, 1-5, 1-6 are the original support part and its compatible RoHS replacement part/assembly.

Table 1-1: 16192A Product Overview

Ref/D	Agilent Part Number	Description	Qty.	RoHS Compliant Replacement Part	Description	Qty.
1	(not assigned)	Main Assembly	1	(not assigned)	Main Assembly	1
2	16193-60002	Magnifying Glass ¹	1	16193-60002	Magnifying Glass	1
3	16192-09002	Insulator	1	16192-09002	Insulator	1
4	8710-2081	Tweezers ¹	1	8710-2081	Tweezers	1
5	16191-29001	Shorting Device (1 1 2.4mm) ²	1	16191-29001	Shorting Device (1 1 2.4mm)	1
6	16191-29002	Shorting Device (1.6 2.4 2mm) ²	1	16191-29002	Shorting Device (1.6 2.4 2mm)	1
7	16191-29003	Shorting Device (2.4 2.4 3.2mm) ²	1	16191-29003	Shorting Device (2.4 2.4 3.2mm)	1
8	16191-29004	Shorting Device (2.4 2.4 4.5mm) ²	1	16191-29004	Shorting Device (2.4 2.4 4.5mm)	1
9	1540-0692	Case for shorting devices	1	1540-0692	Case for shorting devices	1
-	16191-29021	Styrofoam Holder ³	1	16191-29021	Styrofoam Holder	1
-	16192-90040	Operation and Service Manual	1	16192-90040	Operation and Service Manual	1

Remarks:

¹ Contained if you ordered the 16191A option 710.

² Contained if you ordered the 16191A option 701.

³ Not shown in the figure.

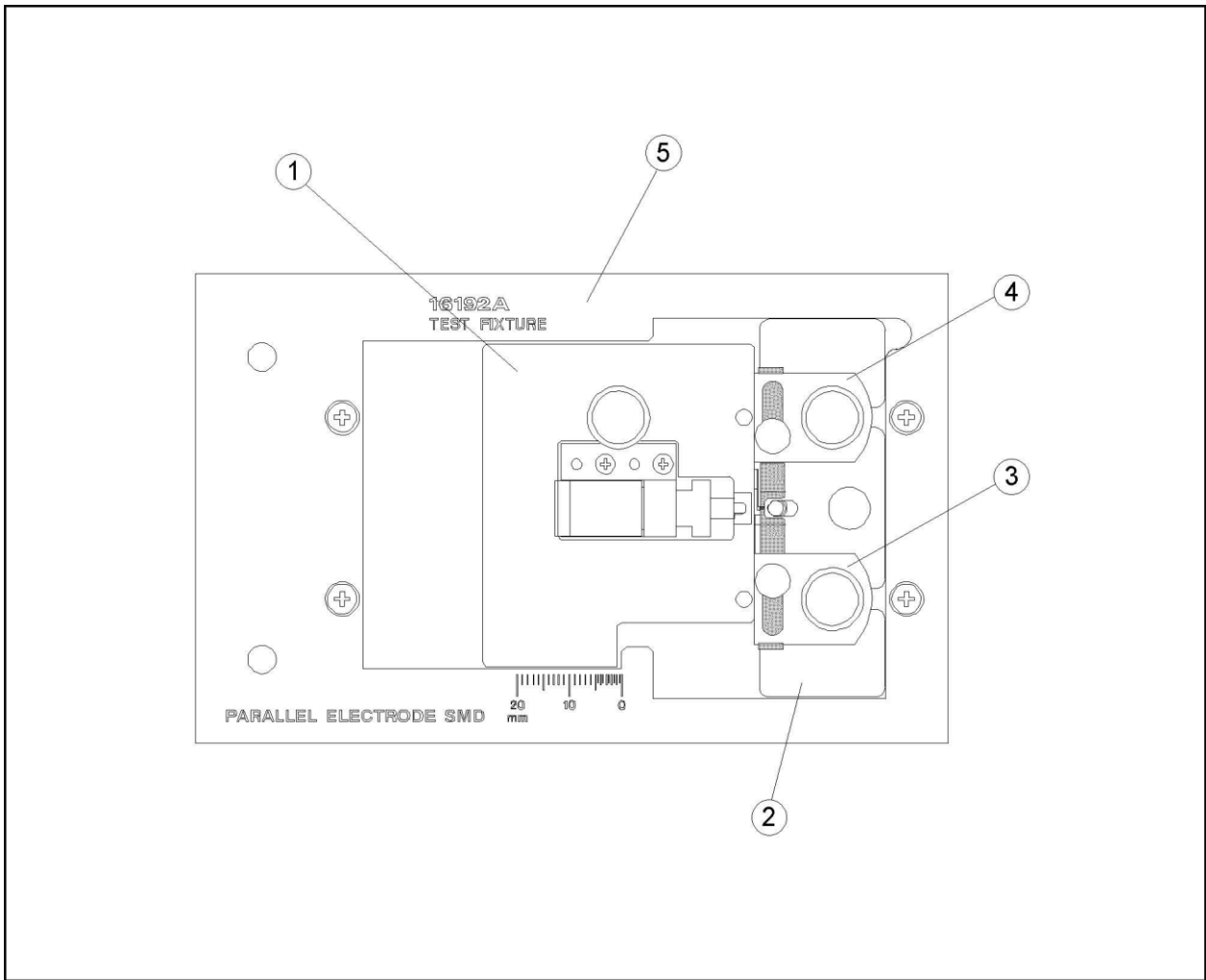

ac104011

Figure 1-2

Table 1-2: Replaceable Parts for Main Assembly

Ref/D	Agilent Part Number	Description	Qty.	RoHS Compliant Replacement Part	Description	Qty.
1	(not assigned)	Length Positioning Stage Assembly	1	(not assigned)	Length Positioning Stage Assembly	1
2	16192-09001	Device Stage	1	16192-09001	Device Stage	1
3	(not assigned)	Width Positioning Stage Assembly	1	(not assigned)	Width Positioning Stage Assembly	1
4	(not assigned)	Width Positioning Stage Assembly	1	(not assigned)	Width Positioning Stage Assembly	1
5	(not assigned)	Test Stage Assembly	1	(not assigned)	Test Stage Assembly	1

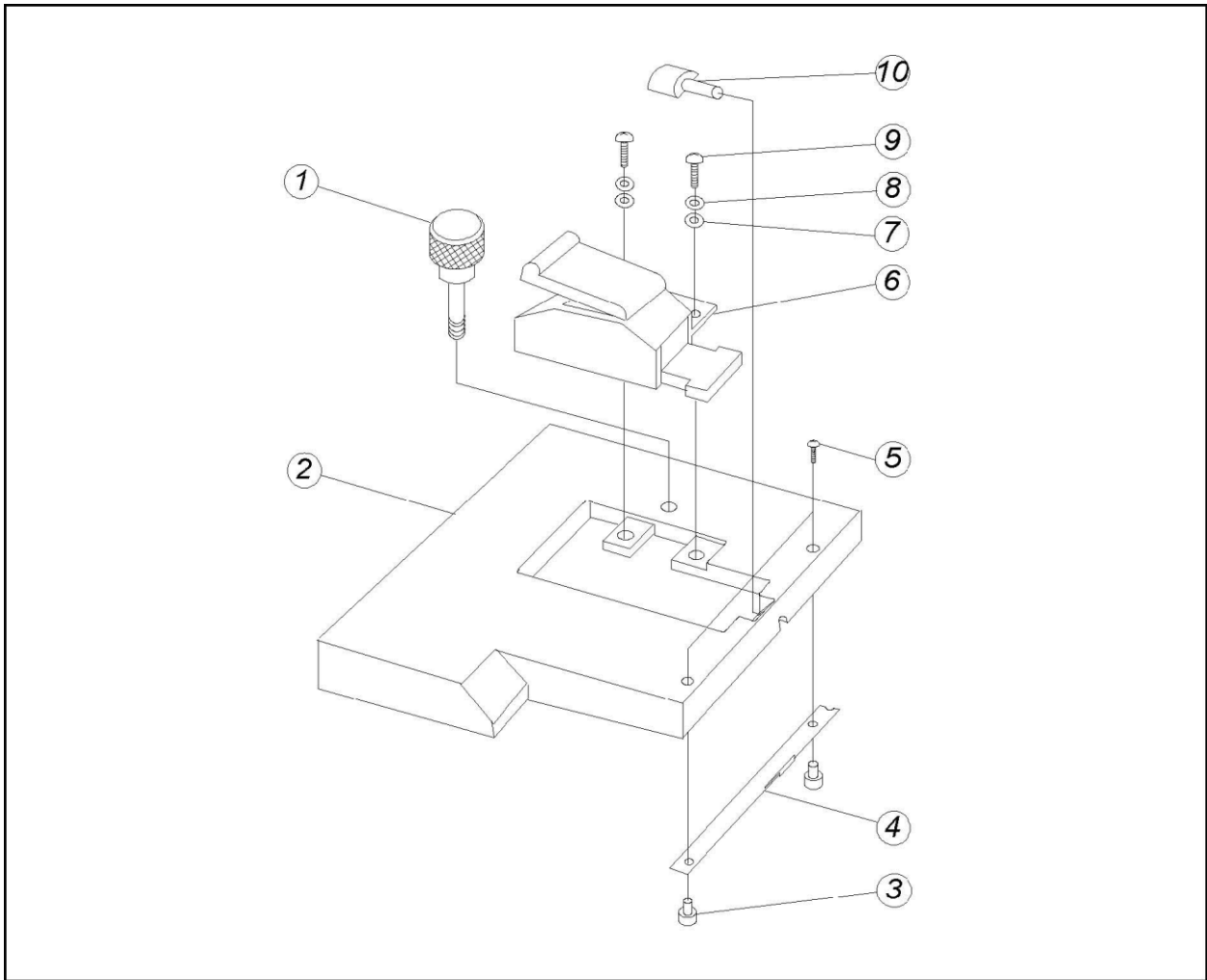

AC104003

Figure 1-3

Table 1-3: Replaceable Parts for Length Positioning Stage Assembly

Ref/D	Agilent Part Number	Description	Qty.	RoHS Compliant Replacement Part	Description	Qty.
1	16192-24006	Length Locking Knob	1	16192-24006	Length Locking Knob	1
2	16192-20002	Length Positioning Stage Block	1	16192-20002	Length Positioning Stage Block	1
3	16192-23001	Nut	2	16192-23001	Nut	2
4	16192-01202	Sheet metal, Contact, Spring Thickness (0.1mm-0.2mm)	1	16192-01202	Sheet metal, Contact, Spring Thickness (0.1mm-0.2mm)	1
5	0515-2421	Screw M1.4L3	2	0515-5363	Screw M1.4L3	2
6	(not assigned)	Insertion Clip Assembly	1	(not assigned)	Insertion Clip Assembly	1
7	3050-1066	Washer	2	3050-1066	Washer	2
8	2190-0654	Washer	2	-	(not used in RoHS product model)	-
9	0515-0976 (0515-2727)	Screw Pan Head M2L6	2	0515-0658	Screw Pan Head M2L6	2
10	16192-25004	Rod	1	16192-25004	Rod	1

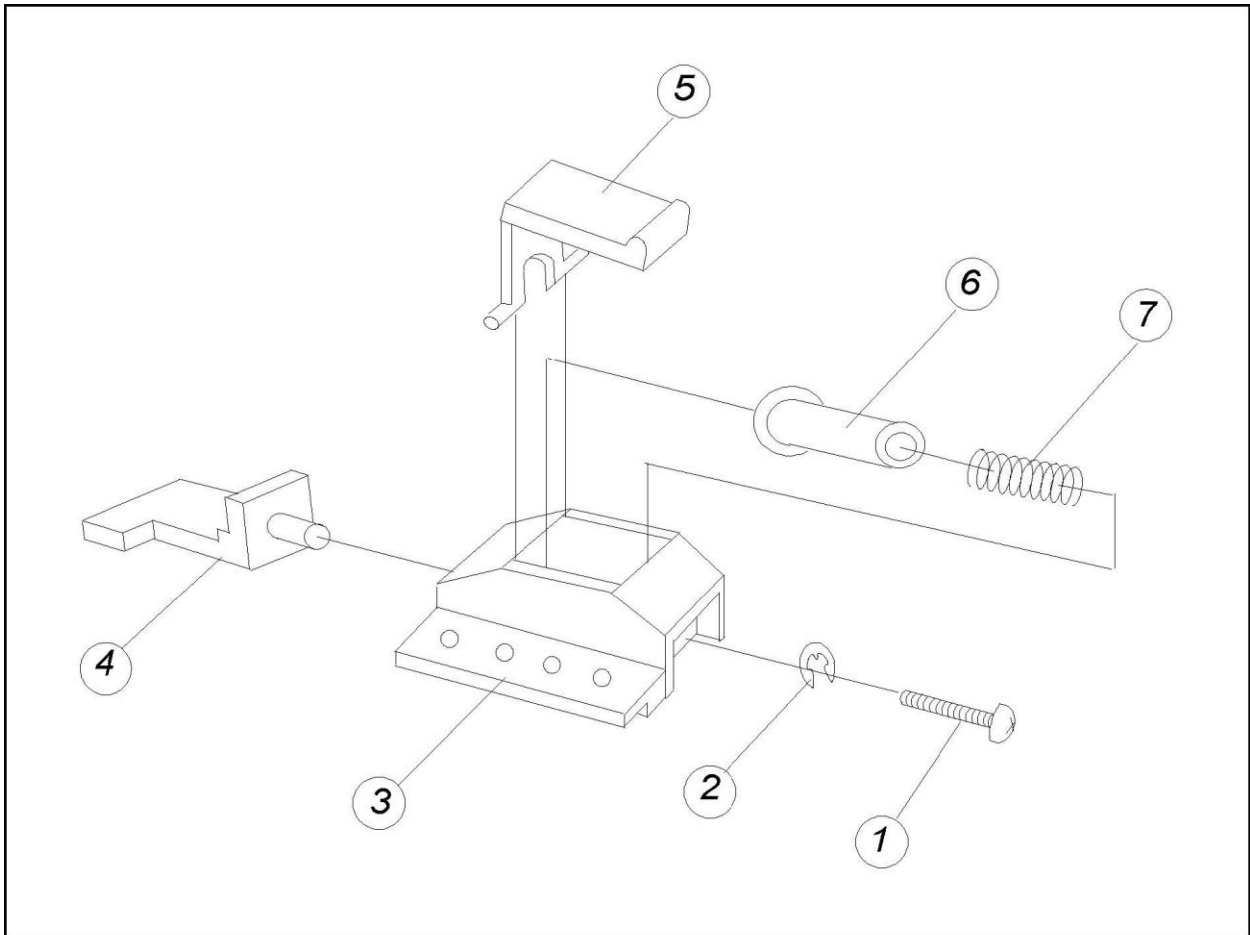

AC104004

Figure 1-4

Table 1-4: Replaceable Parts for Insertion Clip Assembly

Ref/ D	Agilent Part Number	Description	Qty.	RoHS Compliant Replacement Part	Description	Qty.
1	0520-0133	Screw	1	<*1> Set change: 0515-0661	Length Locking Knob	1
2	2190-0014	Washer	1	<*1>Set change : 3050-1066	Washer	1
3	16092-40010	Holder	1	16092-40010	Holder	1
4	16092-40016	Holder	1	<*1>Set change : 16092-40616	DUT Holder	1
5	16092-40011	Lever	1	16092-01201	Lever	1
6	16092-23010	Shaft	1	16092-23010	Shaft	1
7	1460-0352	Spring	1	1460-0352	Spring	1

Remarks:

<*1> Set change. Replace all of the associated parts marked with <*1> as they are mutually dependent.

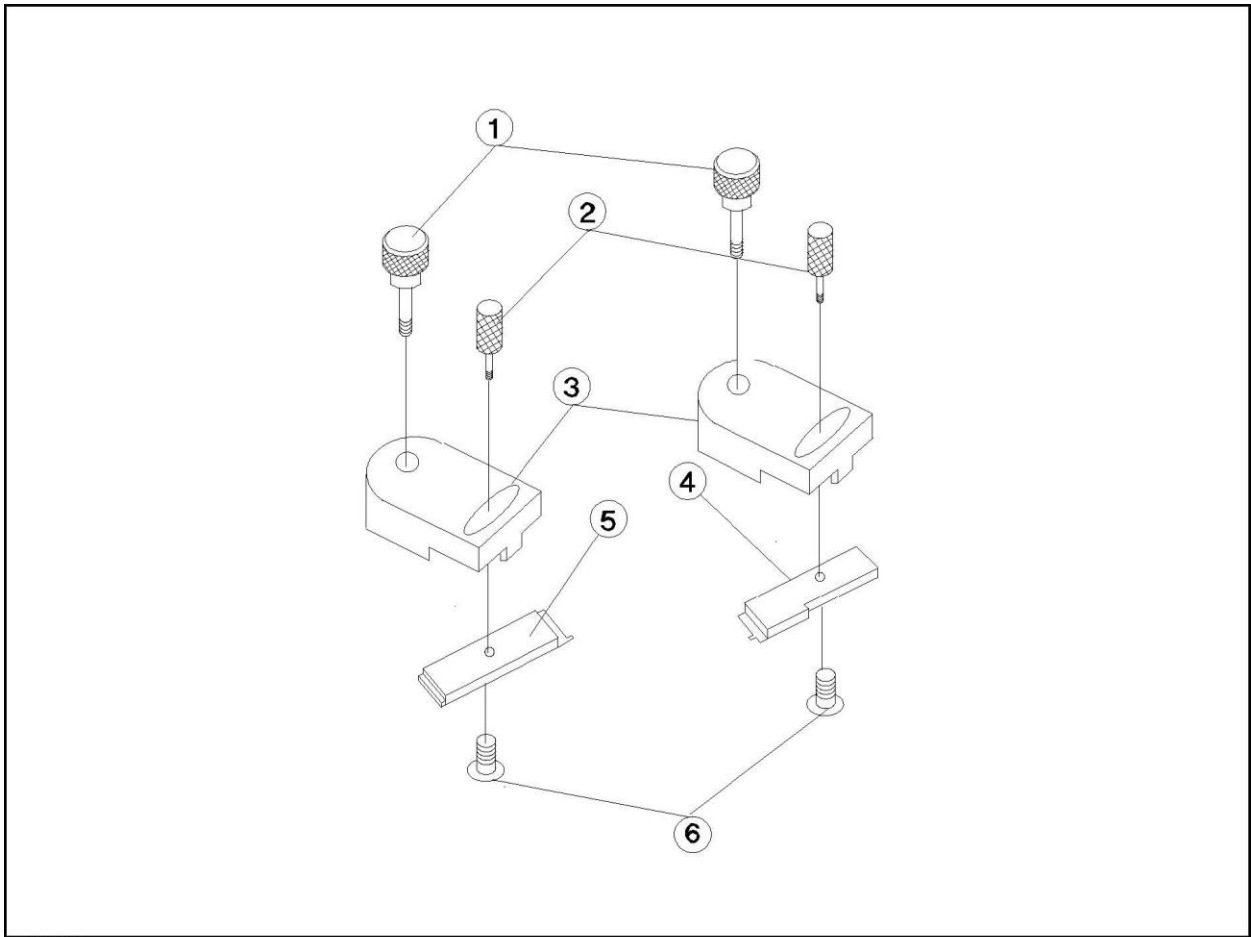

AC104005

Figure 1-5

Table 1-5: Replaceable Parts for Width Positioning Stage Assembly

Ref/ D	Agilent Part Number	Description	Qty.	RoHS Compliant Replacement Part	Description	Qty.
1	16192-24006	Width Positioning Knob	2	16192-24006	Width Positioning Knob	2
2	16192-24005	Device Holder Adjustment Knob	2	16192-24005	Device Holder Adjustment Knob	2
3	16192-24004	Holder	2	16192-24004	Holder	2
4	16192-25002	Device Holder L	1	16192-25002	Device Holder L	1
5	16192-25003	Device Holder R	1	16192-25003	Device Holder R	1
6	0515-0994	Screw Flat Head M2L6	2	0515-1602	Screw Flat Head M2L6	2

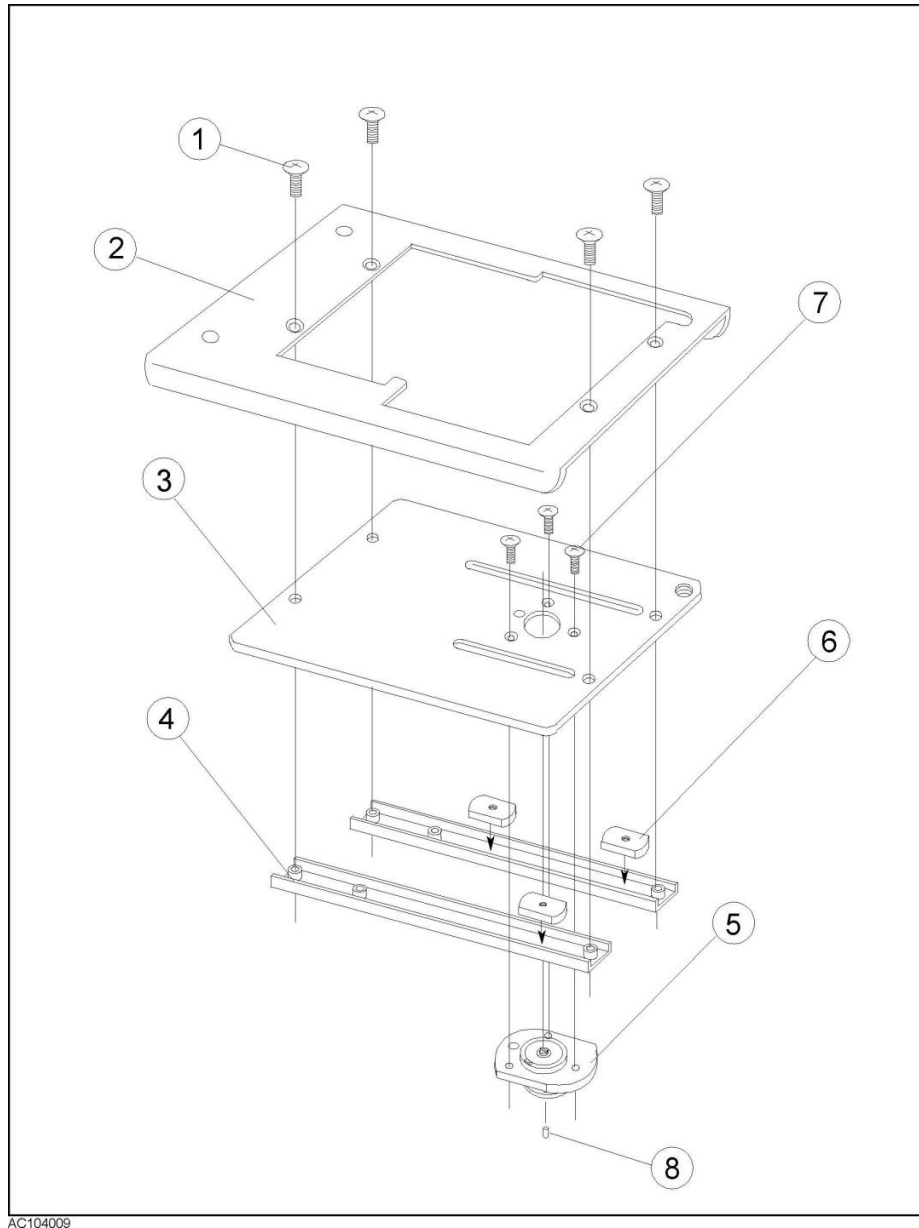

AC104009

Figure 1-6

Table 1-6: Replaceable Parts for Test Stage Assembly

Ref/ D	Agilent Part Number	Description	Qty.	RoHS Compliant Replacement Part	Description	Qty.
1	0515-0914	Screw Flat Head M3L6	4	0515-1227	Screw Flat Head M3L6	4
2	16192-00201	Table	1	16192-00201	Table	1
3	16192-00603	Plate	1	16192-00603	Plate	1
4	16192-01201	Angle	2	16192-01201	Angle	2
5	16192-60001	Contact Assembly	1	16192-60001	Contact Assembly	1
6	16192-24013	Nut	3	16192-24013	Nut	3
7	0515-0952	Screw Flat Head M2L4	3	0515-2151	Screw Flat Head M2L4	3
8	1250-0907	Contact-RF Connector	1	1250-0907	Contact-RF Connector	1

Situation 2:
For RoHS 16192A Parallel Electrode SMD Test Fixture
(S/N: MY432xxxxx and above, SG432xxxxx and above)

Solution/Action:

Shown are the support parts for RoHS compliance 16192A Parallel Electrode SMD Test Fixture. All the listed items are changed at RoHS conversion. Due to limited availability of RoHS compliance station and technical difficulties in RoHS soldering, only parts and support level that do not require RoHS soldering are supported. Shown are the supported RoHS compliance parts for RoHS 16192A Parallel Electrode SMD Test Fixture.

Shown in table 2-1, 2-2, 2-3, 2-4, 2-5, 2-6 and figure 2-1, 2-2, 2-3, 2-4, 2-5, 2-6 are the respective support parts for RoHS compliance 16192A unit. Parts shown below are replaceable parts for RoHS unit.

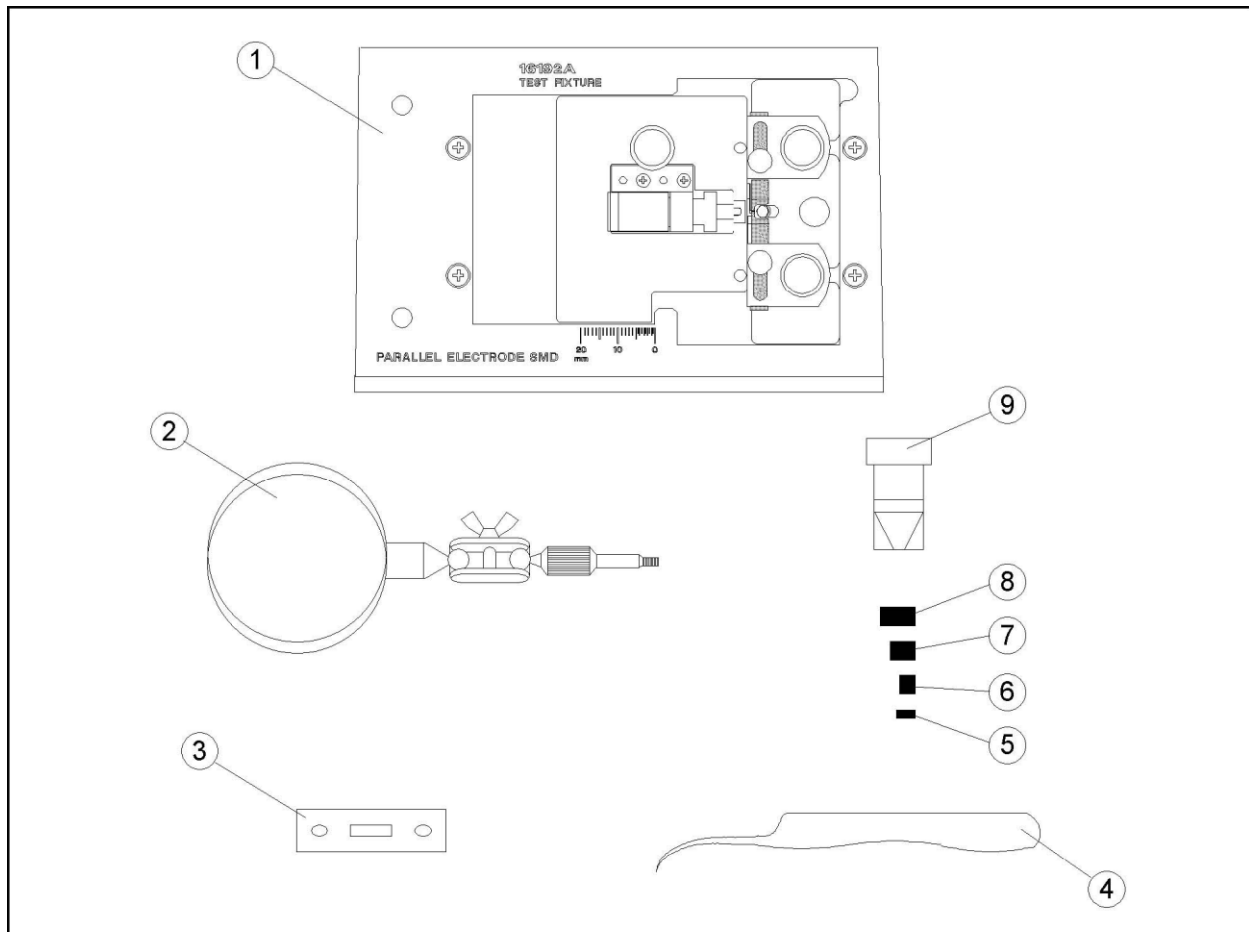

ac104010

Figure 2-1

Table 2-1: 16192A Product Overview

Ref/D	Part Number	Qty.	Description
1	(not assigned)	1	Main Assembly
2	16193-60002	1	Magnifying Glass ¹
3	16192-09002	1	Insulator
4	8710-2081	1	Tweezes ¹
5	16191-29001	1	Shorting Device (1x1x 2.4 mm) ²
6	16191-29002	1	Shorting Device (1.6x2.4x 2 mm) ²
7	16191-29003	1	Shorting Device (2.4x2.4x 3.2 mm) ²
8	16191-29004	1	Shorting Device (2.4x2.4x 4.5 mm) ²
9	1540-0692	1	Case for shorting devices
-	16191-29021	1	Styrofoam Holder ³
-	16192-90040	1	Operation and Service Manual ³

Remarks:

¹ Contained if you ordered the 16191A option 710.

² Contained if you ordered the 16191A option 701.

³ Not shown in the figure.

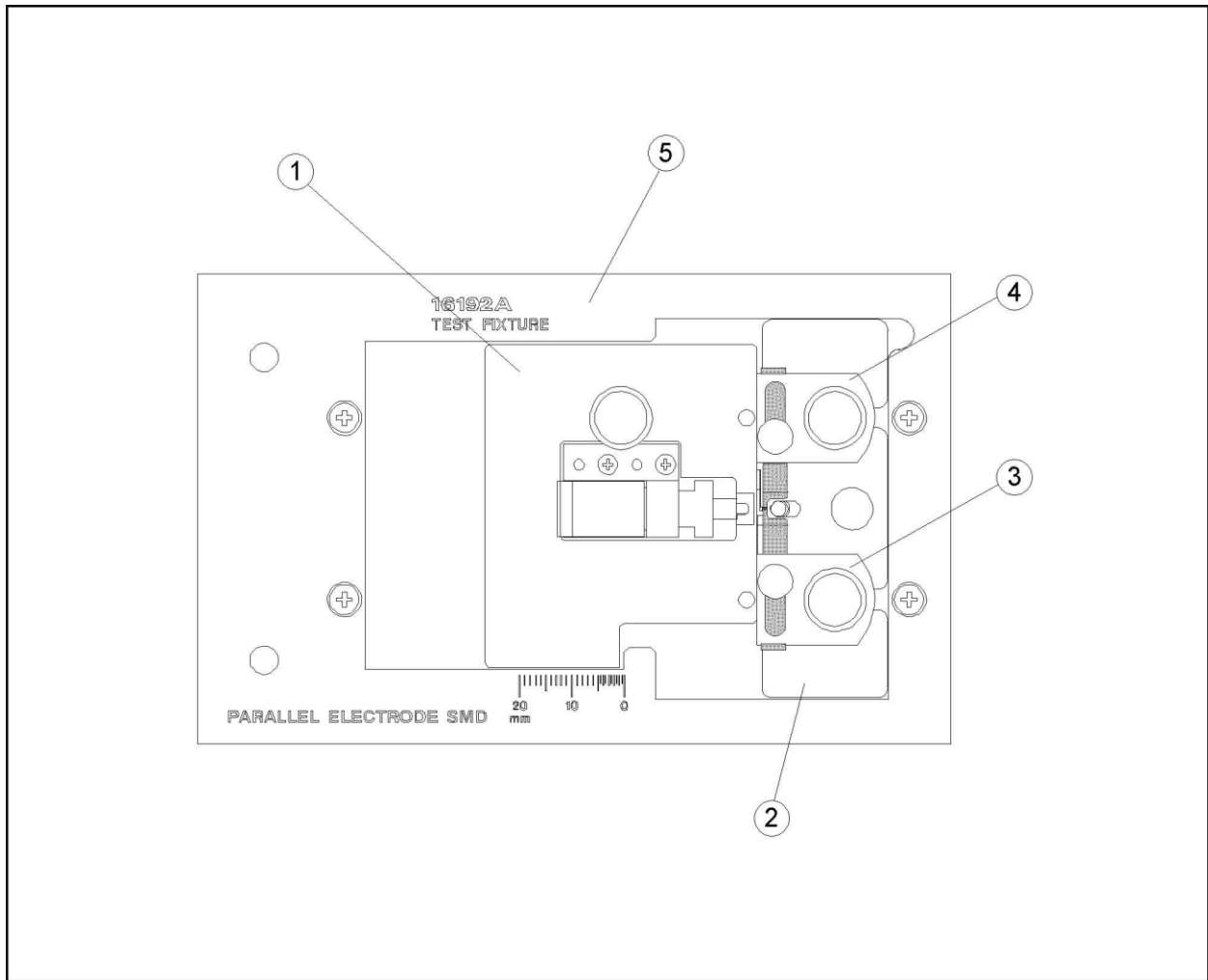

ac104011

Figure 2-2

Table 2-2: Replaceable Parts for Main Assembly

Ref/D	Part Number	Qty.	Description
1	(not assigned)	1	Length Positioning Stage Assembly
2	16192-09001	1	Device Stage
3	(not assigned)	1	Width Positioning Stage Assembly
4	(not assigned)	1	Width Positioning Stage Assembly
5	(not assigned)	1	Device Stage

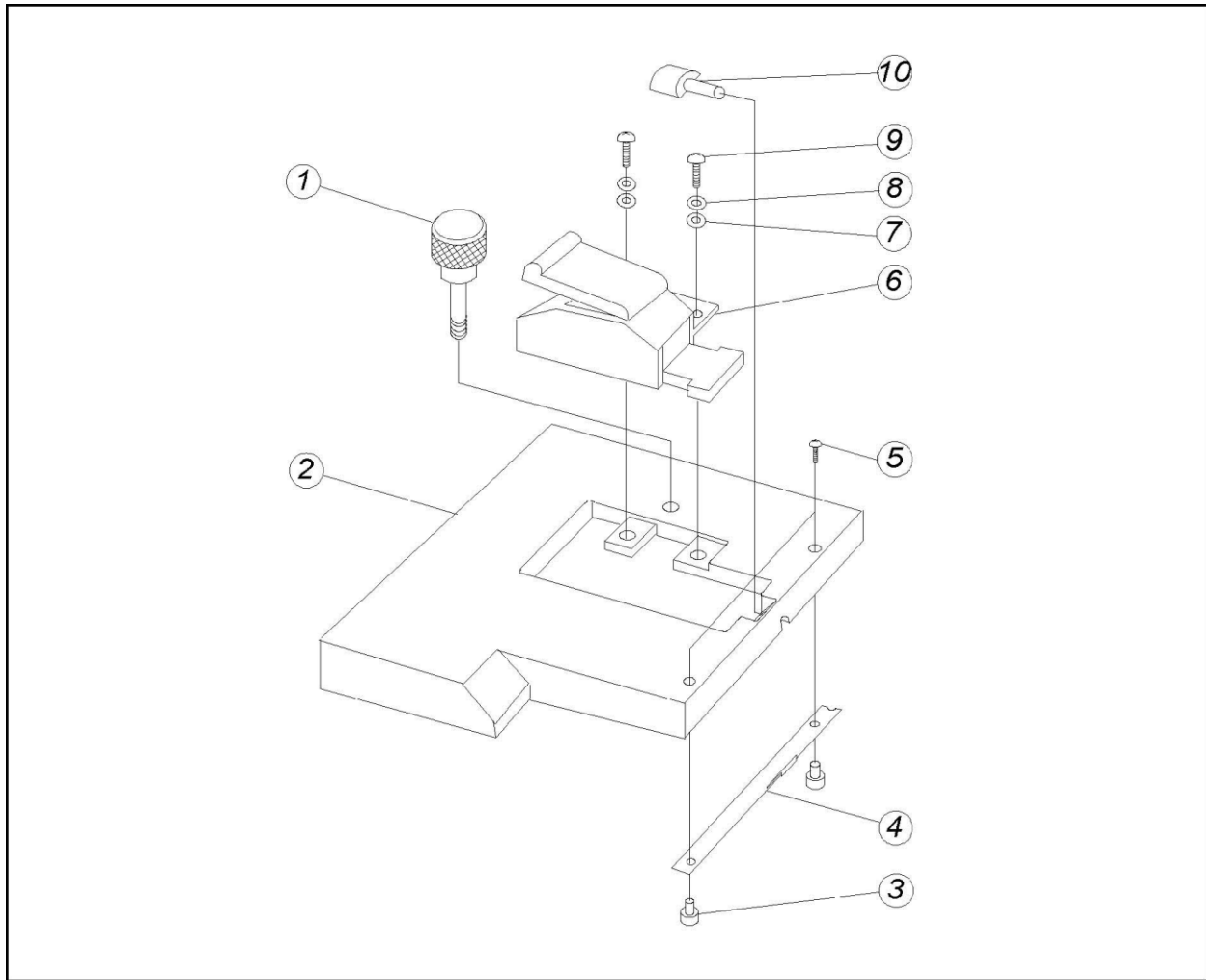

AC104003

Figure 2-3

Table 2-3: Replaceable Parts for Length Positioning Stage Assembly

Ref/D	Part Number	Qty.	Description
1	16192-24006	1	Length Locking Knob
2	16192-20002	1	Length Positioning Stage Block
3	16192-23001	2	Nut
4	16192-01202	1	Contact
5	0515-5363	2	Screw M1.4L3
6	(not assigned)	1	Insertion Clip Assembly
7	3050-1066	2	Washer
8	<i>(Not used in RoHS product model)</i>	-	Washer
9	0515-0658	2	Screw Pan Head M2L6
10	16192-25004	1	Rod

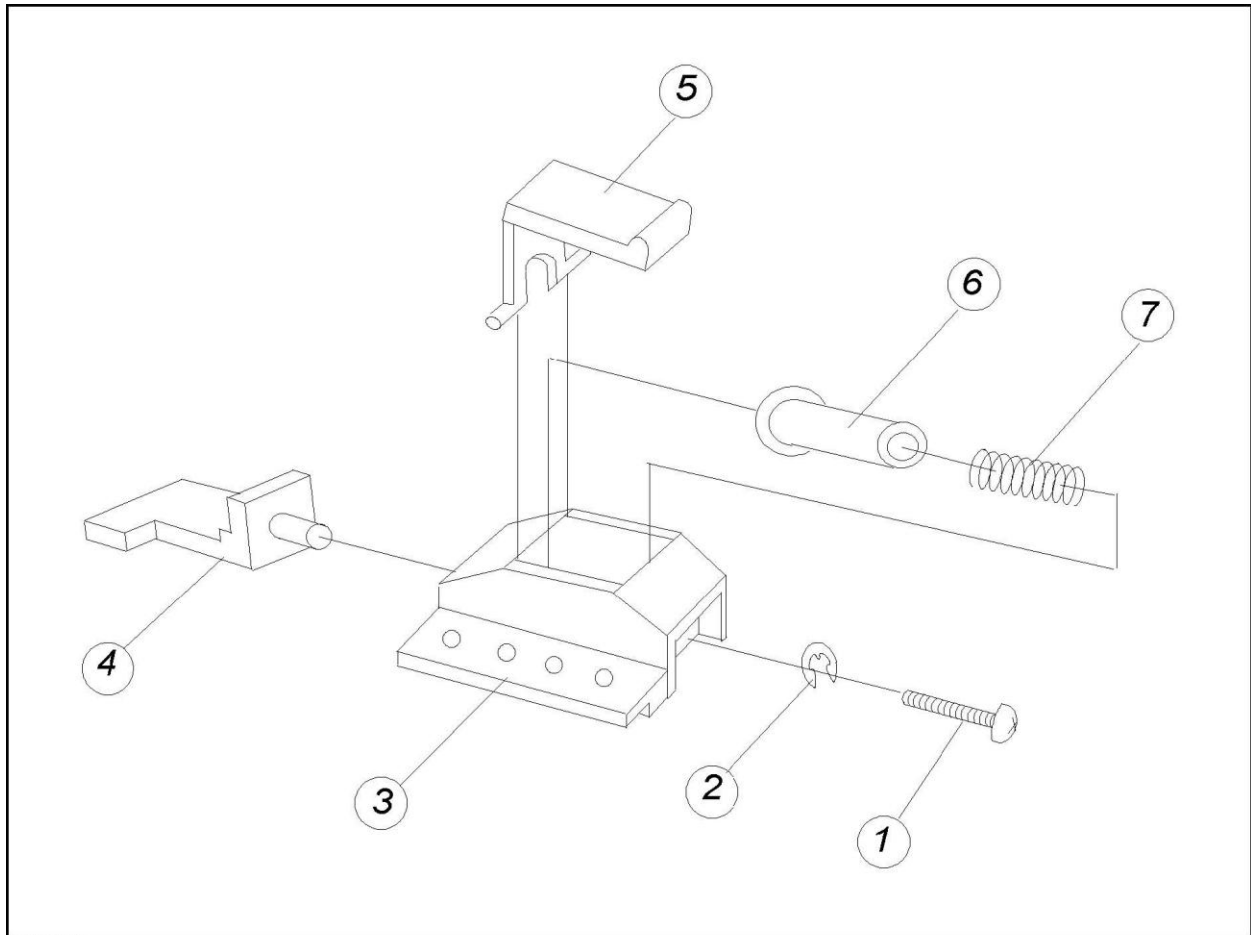

AC104004

Figure 2-4

Table 2-4: Replaceable Parts for Insertion Clip Assembly

Ref/D	Part Number	Qty.	Description
1	0515-0661	1	Screw
2	3050-1066	1	Washer
3	16092-40010	1	Holder
4	16092-40616	1	Holder
5	16092-01201	1	Sheet metal, Clip
6	16092-23010	1	Shaft
7	1460-0352	1	Spring

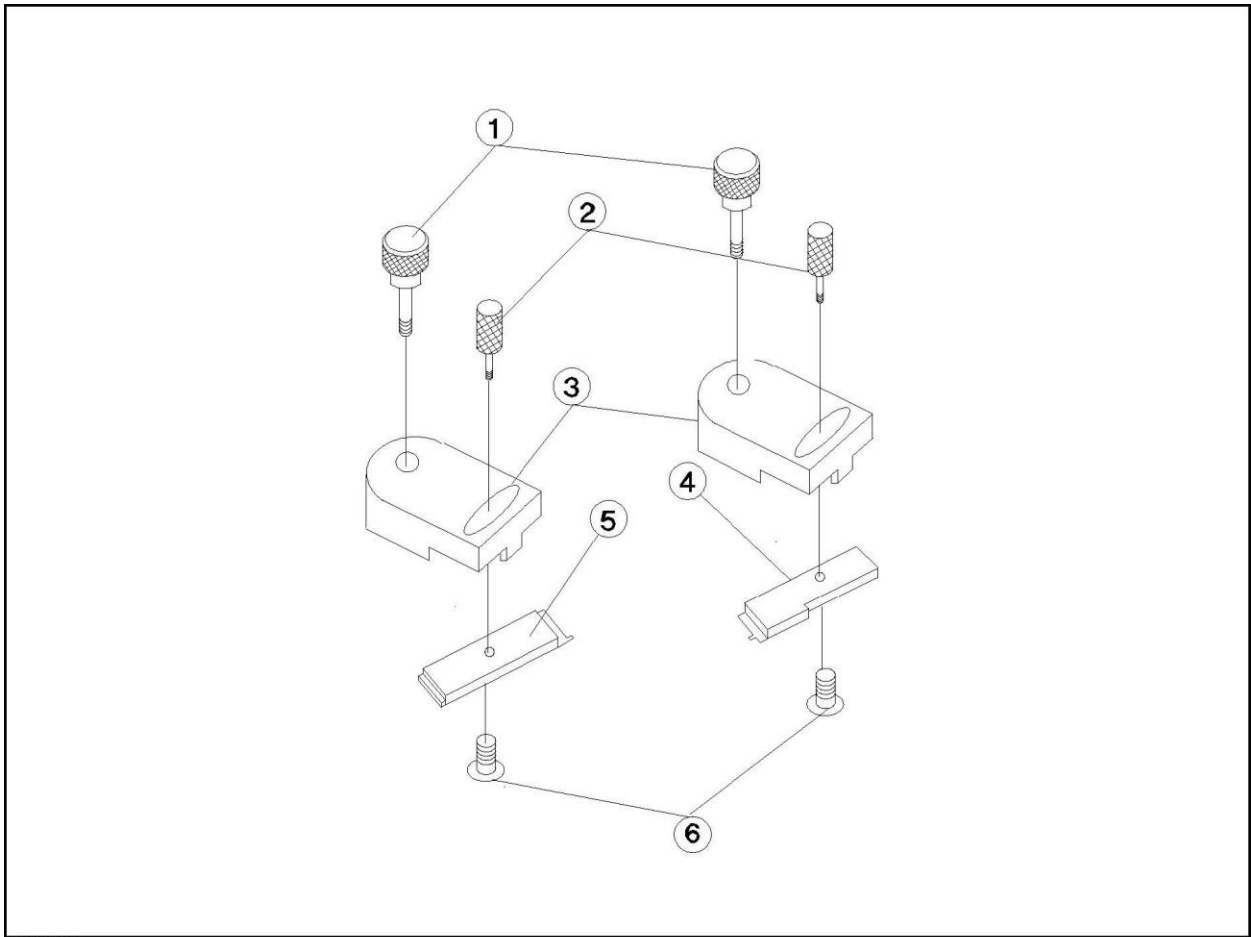

AC104005

Figure 2-5

Table 2-5: Replaceable Parts for Width Positioning Assembly

Ref/D	Part Number	Qty.	Description
1	16192-24006	2	Width Positioning Knob
2	16192-24005	2	Device Holder Adjustment Knob
3	16192-24004	2	Holder
4	16192-25002	1	Device Holder L
5	16192-25003	1	Device Holder R
6	0515-1602	2	Screw Flat Head M2L6

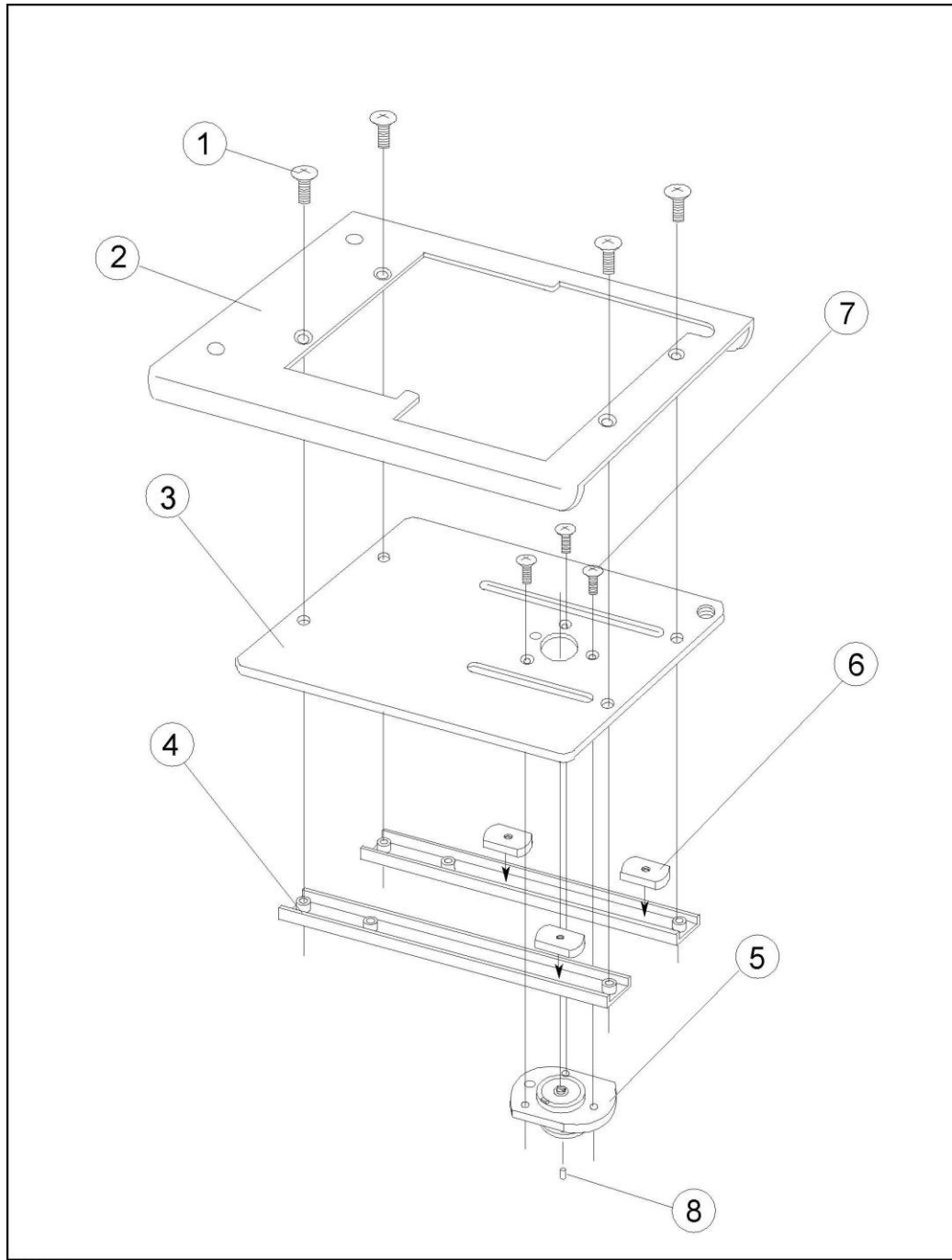

AC104009

Table 2-6: Replaceable Parts for Test Stage Assembly

Ref/D	Part Number	Qty.	Description
1	0515-1227	4	Screw Flat Head M3L6
2	16192-00201	1	Table
3	16192-00603	1	Plate
4	16192-01201	2	Angle
5	16192-60001	1	Contact Assembly
6	16192-24013	3	Nut
7	0515-2151	3	Screw Flat Head M2L4
8	1250-0907	1	Contact-RF Connector

Revision History:

Revision Number	Date	Author	Reason For Change
16192A-03	12 June 2012	LS	As published
16192A-03A	7 May 2013	LS	Separate on non-RoHS and RoHS models part support strategy. Updated 16192-01202 part description.